

DETAIL B

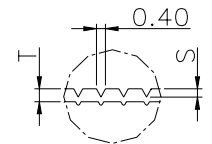

SECTION D-D

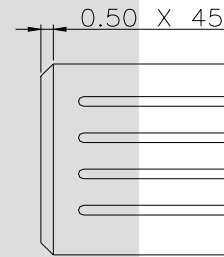
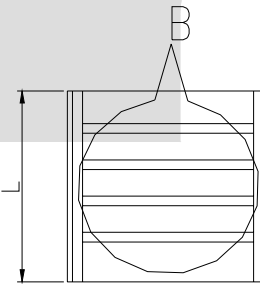
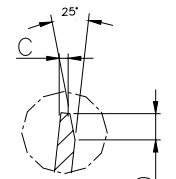

DETAIL A

PUSH PULL RESULT		
DESCRIPTION	AT 1ST INSERTION	AT 10TH WITHDRAWAL
PUSH LOAD MAX.	N A	
PULL LOAD MIN.		N A
MAX. MV. DROP AT 4A	N A	
MAX. MV. DROP AT 4A		N A

DIMENSION CLASSIFICATION	
SYMBOL	DESCRIPTION
▲	CRITICAL

CONTROLLED COPY  
TTPL

CAT. NO.	L	W	H	C	S	D	H1	P	$\phi d1$
TOLERANCE	+0.2 -0.2	+0.2 -0.2	+0.2 -0.2	+0.1 -0.1	+0.04 -0.04	+0.5 -0.3	+0.3 -0.2	+0.05 -0.05	+0.10 -0.10
TT- 1518	8.00	8.00	8.20	0.35	0.15	1.00	13.2	20.5	1.80

NOTES:-

MATERIAL	70/30 BRASS
FINISH	NATURAL
THICKNESS	0.60 <sup>+0.02</sup>
HARDNESS IN VPN	120 - 140

TT-1518

TERMINAL PITCH  $20.50^{+0.05}_{-0.05}$

02	Cable Size	5.90-12.40 mm <sup>2</sup>	5.90-16.00mm <sup>2</sup>	22/11/07	Santosh Komal	201
01	NO. OF SERRATIONS	3	4	13/08/04	AM BN	107
REV.NO.	AL. NO.	WAS	CHANGED TO	DATE	NAME	CHD.BY. ECN NO.
GEN TOL.	CAT NO.	TAB SIZE	CABLE SIZE	ALL DIMENSIONS ARE IN MM		
0-10 ±0.10	TT-1518	-----	5.90-16.00mm <sup>2</sup>			
10-30 ±0.20	DRN BY VENU	CHECKED BY SANTOSH	APPROVED_BY_DATE SUJESH	FILENAME Tt-1518	DATE 14-3-04	SCALE 5:1
30-100 ±0.30	<b>TT</b>			JOINT TERMINAL (CENTRE SPLICE)		
100-300 ±0.50	TERMINAL TECHNOLOGIES (I) PVT. LTD.			DRAWING_NUMBER	D/TT/253.R02	SHEET 1 OF 1

ISSUE NO-1/17-10-02