

SECTION D-D

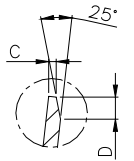

DETAIL A

DIMENSION CLASSIFICATION	
SYMBOL	DESCRIPTION
▲	CRITICAL

DESCRIPTION	AT 1ST INSERTION	AT 10TH WITHDRAWAL
PUSH LOAD MAX.	N A	
PULL LOAD MIN.		N A
MAX. MV. DROP AT 10A	N A	
MAX. MV. DROP AT 10A		N A

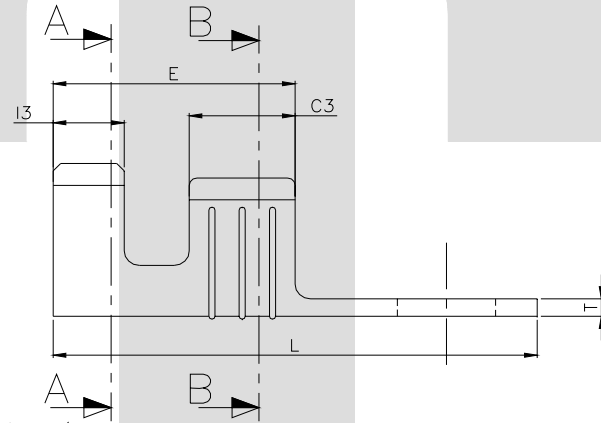
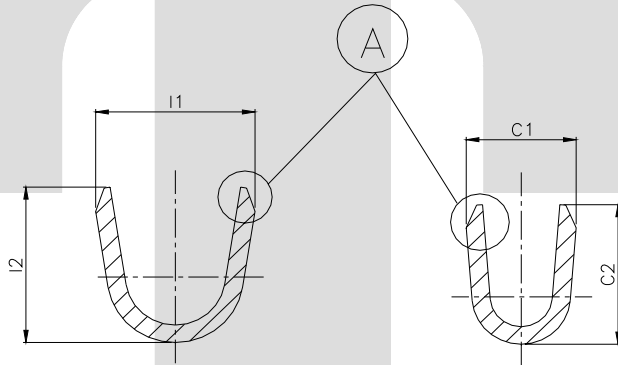

CAT NO.	L	øD	ød	T	C1	C2	C3	I1	I2	I3	D	S	C	P	B
TOLERANCE	+0.30 -0.30	+0.15 -0.15	+0.10 -0.10	+0.02 -0.02	+0.20 -0.20	+0.30 -0.30	+0.10 -0.10	+0.20 -0.20	+0.30 -0.30	+0.10 -0.10	+0.30 -0.30	+0.05 -0.10	+0.20 -0.30	+0.05 -0.05	+0.00 -0.15
TT-1523	32.50	12.0	6.40	1.20	8.00	9.80	7.30	11.3	10.80	5.0	1.30	0.25	0.60	35.0	2.50

CONTROLLED COPY
TTPL

NOTES:-

MATERIAL	BRASS
FINISH	NATURAL
THICKNESS	1.20 ^{+0.02}
HARDNESS IN VPN	115 - 135

TT-1523

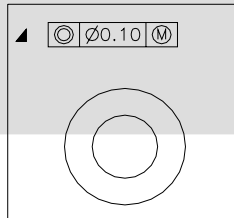

TERMINAL PITCH 35.00^{+0.05}/_{-0.05}
 PLATING THICKNESS:- 1.50 MICRON MIN. IN CASE OF PLATING
 TERMINAL INSERTION FORCE INTO COUPLER:- NA
 TERMINAL WITHDRAWAL FORCE INTO COUPLER:- NA

REV. NO.	AL. NO.	WAS	CHANGED TO	DATE	NAME	CHD. BY
GEN TOL	CAT NO.	CABLE SIZE		ALL DIMENSIONS ARE IN MM		
0-10 ±0.10	TT-1523	8.0 - 15.0mm ²				
10-30 ±0.20	DRN BY VENU	CHECKED BY SANTOSH	APPROVED BY DATE SUJESH	FILENAME TT-1523	DATE 07-03-04	SCALE 3:1
30-100 ±0.30	TT TERMINAL TECHNOLOGIES (I) PVT. LTD.		RING TERMINAL			
100-300 ±0.50			DRAWING_NUMBER	D/TT/258 RO	SHEET 1 OF 1	