

DETAIL B

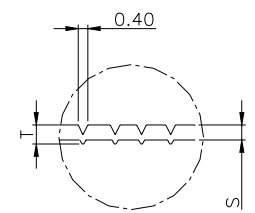

SECTION D-D

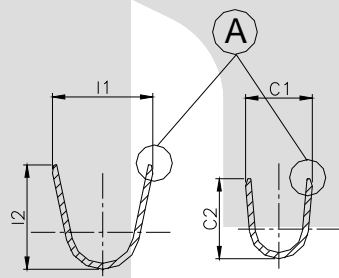

SECTION A-A SECTION B-B

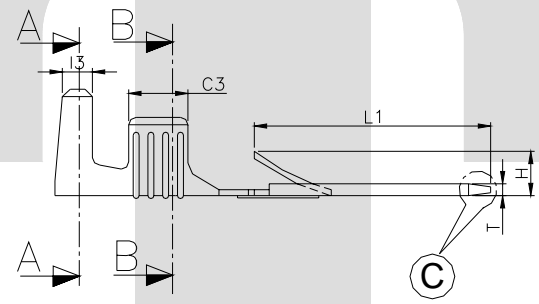

SECTION C-C

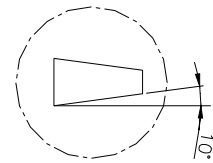

DETAIL C

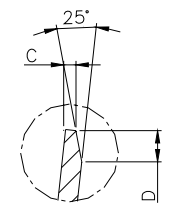

DETAIL A

TERMINAL TO TERMINAL (MALE WITH FEMALE) (TT-1874 WITH 7.60 X 0.80mm FEMALE)		
DESCRIPTION	AT 1ST INSERTION	AT 10TH WITHDRAWAL
PUSH LOAD MAX.	2.5KG	
PULL LOAD MIN.		1.0KG
MAX. MV. DROP AT 20A	10MV	
MAX. MV. DROP AT 20A		15MV

DIMENSION CLASSIFICATION	
SYMBOL	DESCRIPTION
▲	CRITICAL

CAT. NO.	L	E	C1	C2	C3	I1	I2	I3	T	W	G	L1	H	W1	C	S	D	P	B
TOLERANCE	+0.3 -0.3	+0.3 -0.3	+0.2 -0.2	+0.3 -0.3	+0.1 -0.1	+0.2 -0.2	+0.3 -0.3	+0.1 -0.1	+0.4 -0.4	+0.1 -0.1	+0.3 -0.3	+0.4 -0.3	+0.2 -0.2	+0.1 -0.1	+0.1 -0.1	+0.4 -0.4	+0.3 -0.3	+0.5 -0.5	+0.0 -0.15
TT- 1874	29.6	15.4	4.60	5.20	4.00	7.00	7.20	2.10	0.80	7.60	16.5	15.0	2.50	10.0	0.20	0.10	0.60	31.3	1.70

NOTES:-

MATERIAL	70/30 BRASS
FINISH	TIN
THICKNESS	0.38 ^{+0.02}
HARDNESS IN VPN	120 - 145

TT-1874

CONTROLLED COPY
TTPL

TERMINAL PITCH 31.30^{+0.05}_{-0.05}

PLATING THICKNESS:- 1.50 MICRON MIN. IN CASE OF PLATING

TERMINAL INSERTION FORCE INTO COUPLER:- 2.00KG. MAX.
TERMINAL WITHDRAWAL FORCE FROM COUPLER:- 6.00KG. MIN.

02	No. of Serration	3	4	6/06/04	BN	BN	86 A
01	Cl,W,Tol.H	4.80, 7.50	4.60, 7.60, ^{+0.2} _{-0.2}	10-8-03	BN	BN	32
REV.NO.	AL. NO.	WAS	CHANGED TO	DATE	NAME	CHD.BY.	CHD.BY.
GEN TOL.	CAT.NO	TAB SIZE	CABLE SIZE	ALL DIMENSIONS ARE IN MM			
0-10	±0.10	TT-1874	7.6 X 0.80	1.5 - 2.5 mm ²			
10-30	±0.20	DRN BY VENU	CHECKED BY SANTOSH	APPROVED_BY_DATE SUJESH	FILENAME Tt-1874	DATE 20-03-2000	SCALE 3:1
30-100	±0.30				8 MM FOLDED MALE TAB WITH LANCING		
100-300	±0.50				TERMINAL TECHNOLOGIES (I) PVT. LTD.	DRAWING_NUMBER	D/TT/73R02

ISSUE NO-1/17-10-02