

TERMINAL TO TERMINAL (MALE WITH FEMALE) TT-1979 WITH 2.80 X 0.50mm FEMALE		
DESCRIPTION	AT 1ST INSERTION	AT 10TH WITHDRAWAL
PUSH LOAD MAX.	N A.	
PULL LOAD MIN.		N A.
MAX. MV. DROP AT 4A	N A.	
MAX. MV. DROP AT 4A		N A.

DIMENSION	CLASSIFICATION
SYMBOL	DESCRIPTION
▲	CRITICAL

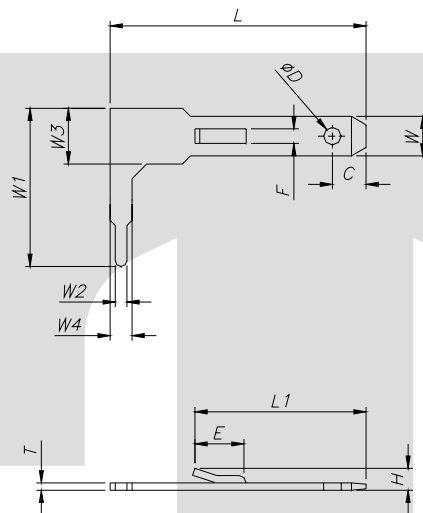

**CONTROLLED COPY
TTPL**

CAT. NO.	L	L1	W	W1	W2	W3	W4	C	H	E	T	ϕD	F
TOLERANCE	+0.2 -0.2	+0.1 -0.1	+0.05 -0.1	+0.1 -0.1	+0.05 -0.1	+0.1 -0.1	+0.1 -0.1	+0.1 -0.1	+0.1 -0.1	+0.1 -0.1	+0.02 -0.02	+0.1 -0.1	+0.1 -0.1
TT- 1979	17.5	11.8	2.80	10.8	0.80	3.80	1.50	2.30	1.50	4.00	0.50	1.20	1.00

NOTES:-

MATERIAL	70/30 BRASS
FINISH	TIN
THICKNESS	0.50 ±0.02
HARDNESS IN VPN	120 - 140

TT-1979

PLATING THICKNESS:- 3.00 MICRON MIN. IN CASE OF PLATING
 TERMINAL INSERTION FORCE INTO COUPLER:- 1.50KG.MAX. ▲
 TERMINAL WITHDRAWL FORCE INTO COUPLER:- 6.00.KG.MIN. ▲

REV. NO.	AL. NO.	#AS	CHANGED TO	DATE	NAME	CHD. BY.
GEN. TOL.	CAT. NO.	TAB SIZE	CABLE SIZE	ALL DIMENSIONS ARE IN MM		
0-10 ±0.10	TT-1979	2.80 X 0.50	N A			
10-30 ±0.20	DRN BY VENU	CHECKED BY SANTOSH	APPROVED BY_DATE SUJESH	FILENAME Tt-1979	DATE 2-6-03	SCALE 3:1
30-100 ±0.30	TT		MALE TAB WITH LANCING			
100-300 ±0.50	TERMINAL TECHNOLOGIES (I) PVT. LTD.		DRAWING_NUMBER	D/TT/206 RO	SHEET 1 OF 1	